

MODIFICATION RECOMMENDED –  
CORRECTS MANUFACTURING OR DESIGN DEFECTS

**E5270A-01**

# **S E R V I C E N O T E**

Supersedes:  
NONE

## E5270A 8 Slot Parametric Measurement Mainframe

Serial Numbers: JP10L00100/JP10L00125

### SMU Modules may be Intermittently Unrecognized

To Be Performed By: Agilent-Qualified Personnel

#### Parts Required:

<u>P/N</u>	<u>Description</u>	<u>Qty.</u>
E5270-01203	Power supply cable guide	1
E5280-00201	HPSMU module front panel	up to 4
E5281-00201	MPSMU module front panel	up to 8

## ADMINISTRATIVE INFORMATION

SERVICE NOTE CLASSIFICATION:			
<b>MODIFICATION RECOMMENDED</b>			
ACTION CATEGORY:	<input type="checkbox"/> IMMEDIATELY <input type="checkbox"/> ON SPECIFIED FAILURE <input checked="" type="checkbox"/> AGREEABLE TIME	STANDARDS:	LABOR: 1.0 Hours
LOCATION CATEGORY:	<input type="checkbox"/> CUSTOMER INSTALLABLE <input type="checkbox"/> ON-SITE <input checked="" type="checkbox"/> SERVICE CENTER	SERVICE INVENTORY:	<input type="checkbox"/> RETURN <input type="checkbox"/> SCRAP <input checked="" type="checkbox"/> SEE TEXT
AVAILABILITY:	PRODUCT'S SUPPORT LIFE	USED PARTS:	<input checked="" type="checkbox"/> RETURN <input type="checkbox"/> SCRAP <input type="checkbox"/> SEE TEXT
AUTHOR: SY	PRODUCT LINE: 1H	AGILENT RESPONSIBLE UNTIL: March, 2005	
ADDITIONAL INFORMATION:			

© AGILENT TECHNOLOGIES, INC. 2003  
PRINTED IN U.S.A.



March 26, 2003

**Situation:**

The E5270A within the listed serial number range may have the problem that the installed SMU modules are intermittently unrecognized by CPU board (5270A). Typically, this problem disappears if you uninstall and reinstall the SMU modules.

**Solution/Action:**

When you repair or calibrate the E5270A, check the serial number, manufacturing date code (MDC) labeled on the SMU modules, and power supply cable guide.

The improved SMU module has the MDC of 4307 or below as shown below. If the MDC is 4306 or above, replace the SMU front panel with improved one (p/n E5280-00201 and p/n E5281-00201).

E528x-xxxxx 33-xxxx xxxx-4307 MADE IN JAPAN
--

The following figure shows the defective cable guide and improved cable guide. If the cable guide is defective one, replace the cable guide with improved one (p/n E5270-01203).

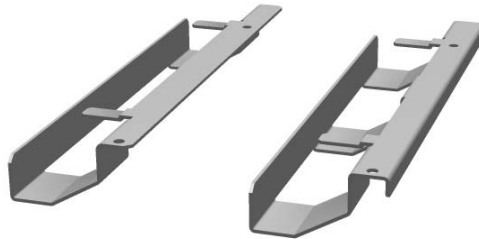

Defective part

Improved part

Prior to use the SMU modules and power supply module for repair, confirm that improved parts are used. If you find the parts apply to this service note in your support inventory, replace the front panel or cable guide. Then use the parts for the repair.